



| **SYNLAWN**®

## Installation Guidelines

# 01 Measuring The Area

This is the start to a detailed but simple instructional guide to correctly installing SYNLawn®. Be sure to carefully survey the area and begin measuring.

## NOTE

If this is a front yard, always face the grain direction toward the street for best curbside appearance.

## NOTE

If this is a front yard, always face the grain direction toward the street for best curbside appearance.

## Mistakes can cost money.

**Measure the job carefully.** If you have many curves and irregular shapes, we recommend adding 10--20% more turf than your area's actual square footage. When designing, try to install the turf in 15--foot wide sections. The turf is sold in 15' widths (example 15' x 20'). Use graph paper, a sketchpad or an iPad to record all measurements and note grain direction. ▶

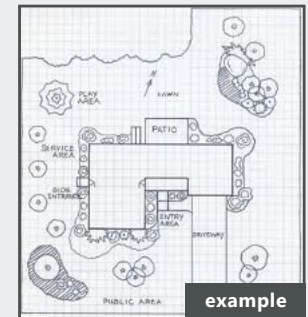

When designing, always keep the grain direction the same and try to face it toward the direction it will be seen most often. Sometimes you will need to lay the turf in a direction that isn't best, but it may make sense to eliminate unnecessary waste.

We suggest you measure as close to exact numbers as possible rather than estimating by total square footage.

In high traffic paths, we recommend installing a pathway of stepping stone or pavers. This will help prevent the turf from matting down and the need for more frequent maintenance.

### Calculations (measure in 15' wide sections when possible)

#### Area 1

length (at longest point) x width = \_\_\_\_\_

Area 2 & 3: length x width = \_\_\_\_\_

Area 1+Area 2+ Area 3 = \_\_\_\_\_ total sq. ft.

Total sq. ft. / 15 = \_\_\_\_\_ total linear feet needed Order turf as 15' x \_\_\_\_\_ (total from above)



### Suggested Tools

Measuring Wheel

Tape Measure

Marking Paint

Sketchpad or iPad

# Estimating Materials

The drawing to the right indicates a sketch for a typical yard. In this case, there is an area with plants (bottom left) that will not require turf. As you can see there is a 15'x16' area and a 9'x7' area so this project would require a seam, indicated by the dotted line between the 2 sections.

## NOTE

- Always measure to the longest point.
- You will need about 1 ton of aggregate or base material for every 100 sq. ft. at a 3" depth. This project would require approximately 3 tons of aggregate. For each ton of aggregate, you are looking at approximately 13-16 wheelbarrows full that will need to be hauled to the project area from the staged dumping area.

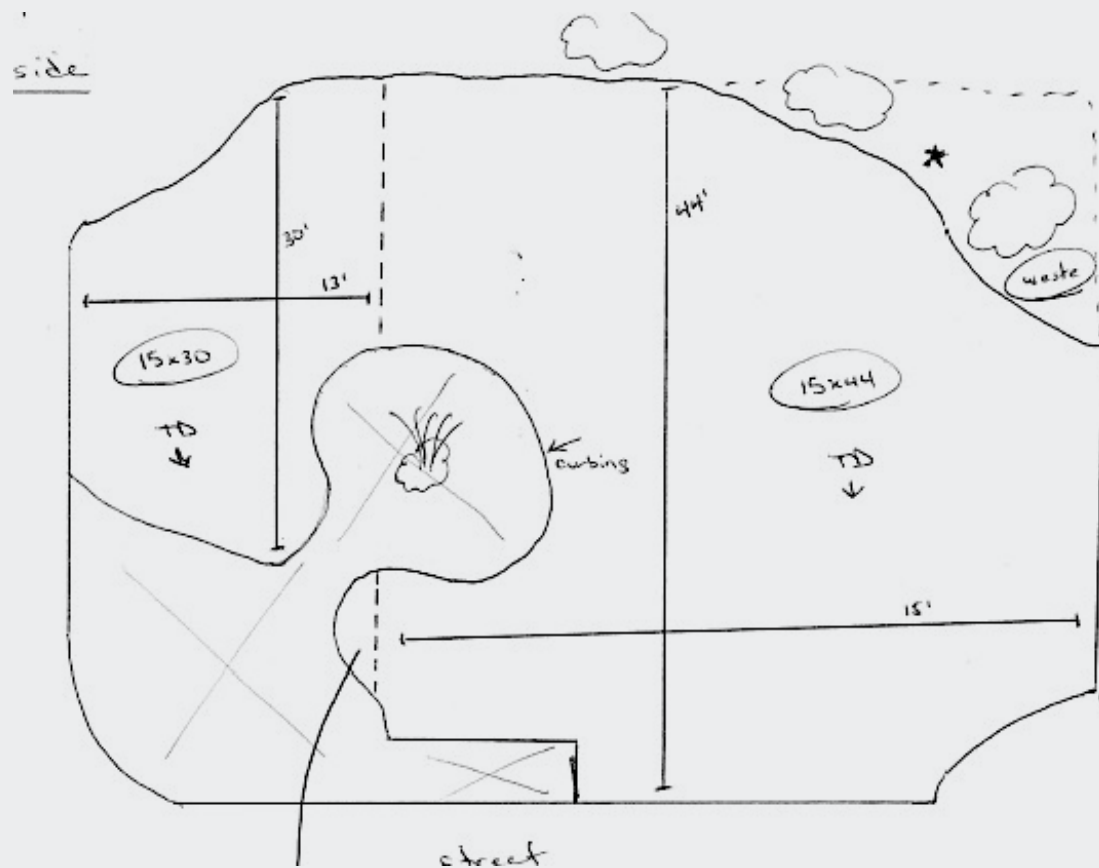

## To estimate artificial grass needed

### Area 1

15' x 16' = 240 sq. ft. This requires a 15'x16' piece of turf.

### Area 2

7' x 9' = 63 sq. ft. This will require a 15' x 9' piece of turf.

**Note for Area 2:** Even though this area is only 7' wide, you must purchase in 15' widths. So you would need a 15' x 9' piece of turf for this area and would have an 8' x 9' piece of turf leftover.

### Total turf needed

15' x 16' + 15' x 9' = 15' x 24' or 360 sq. ft. of turf.

## To estimate base material

Figure out the total square feet for the area requiring turf

### Area 1

240 sq. ft. + Area 2: 63 = 303 sq. ft.

Total sq. ft. / 100 = # of tons of aggregate at 3" depth

## To estimate other materials

**Seaming cloth** | Measure full length of area to be seamed. In this case you would need about 12' of seam tape.

**Adhesive** | 1 qt. of Henry's glue will cover about 15-20' or one tube of Heavy Duty Liquid Nails covers about 20 linear ft.

**Nails** | Nails should be placed about every 6-8" around the perimeter and staggered along seam.

# 03

## Site Preparation

- ▶ Have the project site's water turned off a few days before starting the synthetic turf installation.
- ▶ Be sure all of the project site's sprinklers are removed and capped off or cut the irrigation valves.



Suggested Tools

Sod Cutter

Flat Shovel

### NOTE

Don't forget to run drip lines to trees or plants that were receiving water from this source.

- ▶ Treat any weed or rodent problem prior to the installation. Gopher wire (hardware cloth) can be installed under the synthetic turf's base. Weed barrier can also be used to help prevent further growth.
- ▶ Take note that you will need to determine the proper amount of base material (decomposed granite or recommended base material for your area).
- ▶ You will need to remove the grass, dirt, rock or whatever is in the area the SYNlawn will be installed. Depending on your area, you will need to remove between 3"- 4" to create an adequate drainage base.
- ▶ Use a sod cutter or flat shovel and haul away material.
- ▶ Grade sub grade level and compact if needed.
- ▶ If there is no grass and the yard consists of dirt, pay close attention to the depth in all areas to determine the amount of base material needed.



Click for watch the Base Preparation video!

**Calculations** (measure in 15' wide sections when possible)

( 3" in depth – Total sq. ft. of area ) / 100 = \_\_\_\_\_

( 4" in depth – Total sq. ft. of area ) / 80 = \_\_\_\_\_

**This calculation will provide you with the total TONS of base material needed.**

# 04 Installing The Base

All great lawns have a solid base and in this step be sure to go over the area several times and remove any large rocks or objects from the soil.



## Suggested Tools

Hand Tamp

Vibratory Plate Compactor

Rake

Wheelbarrow

### NOTE

When installing next to a concrete slab or walkway the compacted base should be 1" to 1.5" below the surrounding grade level. This depends on pile height of turf and project design.

- ▶ Rock yards use different materials to create Road Base. Please inquire with your SYNLawn dealer or local rock company to determine the best option for your area and which product is best suited for your compacted drainage bed.
- ▶ Install weed barrier on top of prepared sub grade if needed for tough weed problems.
- ▶ Haul base material from street using wheelbarrows and dump in desired area until you create a 3"- 4" base.
- ▶ Using a grading rake, prepare the base level for proper drainage.
- ▶ Water down graded base area to help with base compaction.
- ▶ Use a vibratory compactor to compact base until you reach an 80% compaction rate. A hand tamper should be used to reach small or tight areas. Improper or incomplete compaction could result in improper drainage. Repeat as needed to acquire desired base.
- ▶ If needed, a small amount of fines, DG (decomposed granite) or stone dust can be used to fill in any large pits in the compacted base.



## Special Considerations

These are important things to note about the different types of turf you'll be installing.



### PET PROJECTS

It is especially important to note when installing synthetic grass in pet areas to take special precautions in regard to odors. It is highly recommended to use zeolite product for this purpose. Depending on which brand of products you are using, follow the recommended guidelines for installation. Some products need to be applied on top of the base, others are better as infill, and sometimes it is suggested to do both. Acquire zeolite information from your SYNLawn distributors.

It is also recommended to use nails every 4" – 6" apart on all pet projects. Installing a perimeter board around the area to secure the turf is ideal but not required.

Be sure to convey to the customer that any pet projects will require additional maintenance and issue a copy of our Care & Maintenance Instructions.



### PLAYGROUND PROJECTS

We can create fall zones with safety specifications up to 12' under playground equipment using an underlayment foam pad. Ask your SYNLawn distributor about these options for increasing the grade and creating safety specifications using underlayment foam products. Installation training may also be available as there are many important things to know when installing foam pad to ensure a proper installation.



### PLAYGROUND PROJECTS

Putting green installations require special instructions for a quality putting green. Please talk to your SYNLawn distributor about special training to teach you about these proper procedures as well as ensuring you know which products and accessories are best suited for each project.

# 05

## Turf Installation

Be sure to follow these instructions carefully when installing the turf. Before nailing the turf into the base be sure to survey the area and smooth out any inconsistencies.

### NOTE

If turf is being installed over concrete, a glue-down method may be used and no base is required.

- ▶ Unroll and cut turf in the client's driveway or in a large open area. Slightly overmeasure being cautious so you are not left short on the job.
- ▶ Before laying the turf, be sure the grain direction aligns with the original design.
- ▶ Lay the turf in the desired area before you make any other cuts.
- ▶ The final detail cuts are made after turf is nailed in place. Always cut turf from the back side.
- ▶ Place cut turf on the completed base in install location.
- ▶ Using 6" (60d) galvanized nails, nail one end of the turf section, tightly pulling other end in place. If turf section is large, you can kick the turf forward using your feet, this helps tighten the turf into place. Nail the other end into base. All turf edges should be secured with nails every 8" to 12", nailing through the turf and into the base. Be careful not to crimp the turf fibers under the nail heads.
- ▶ Perform final detail cuts and nail into base.

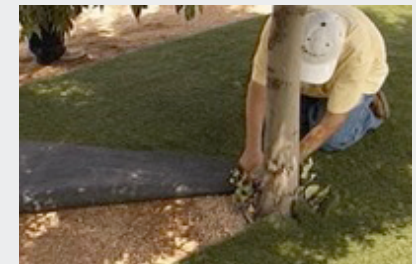

### Suggested Tools

Carpet Knife

Loop Pile Cutter

# 06

## Turf Seaming

In this step you'll be connecting the turf so follow these steps carefully and be sure to smooth out the rolls of turf before seaming.

- ▶ With the turf sections side by side, make sure all of the rows are aligned in the same direction.
- ▶ Try to maintain equal spacing between the fiber rows.
- ▶ Nail each side of the turf into the base, staggering the nails every 8"- 12" apart.
- ▶ Use seam tape to connect the turf sections together. Use recommended adhesive and spread with a trowel onto the seam cloth and carefully lay the turf over onto the seam cloth. The seam will need time to dry or cure based on recommended curing times by adhesive manufacturer. Adding weight like bags of sand on the seams helps create a better bond.
- ▶ Take your time on the seams. The more time and attention you give to details on the seams, the better they will turn out.



Click for watch the Turf Prep & Seaming video!



Suggested Tools

Trowel



# 07 Final Steps

Follow these final steps carefully and be sure to review the checklist at the end of this document for any potential missed steps.



## Suggested Tools

Coarse Bristle Nylon Broom

Grandi Groomer

Power Broom

Drop Spreader

### NOTE

Be sure your levels of sand are consistent throughout.

- ▶ After all the turf is installed and secured to the base, we recommend adding a layer of sand onto the turf fibers. Coated sand, silica sand or zeolite can be used to infill the turf. Use a drop seed spreader to evenly disperse sand. Be sure to broom the sand into the turf so it migrates to the primary backing. We recommend about 1-2 lbs. of sand per sq. ft., depending on the application and the product. The sand acts as ballast and helps protect from UV rays.
- ▶ With each layer of sand, the turf needs to be vigorously brushed using a power broom, Grandi Groomer or coarse bristle nylon broom. The sand will help support the fibers to stand upright. The turf should be brushed across the fibers.
- ▶ The turf seams should be cross-brushed in both directions. This will make the seams less visible.
- ▶ After installation is complete, the entire area needs to be cleaned. All excess sand or debris should be removed and hauled away. Turf and surrounding concrete should be sprayed down with water. The synthetic turf is ready to enjoy!



[Click for watch the Trim & Secure video!](#)



# Project Checklist

Ordered base material

Double checked measurements for accuracy to ensure no material shortages

Ordered SYNLawN

Ordered accessories

Sand

Nails

Glue (if seams are needed)

Irrigation items (if needed)

Seam Cloth (if seams are needed)

Have all required tools (below is a list of tools you may or may not need, depending on the size of the project)

Measuring wheel

Hand Tamp

Trowel

Tape Measure

Vibratory Plate Compactor

Stiff Bristle Nylon Broom

Marking Paint

Rake

Grandi Groomer

Sketchpad or iPad

Wheelbarrow

Power Broom

Sod Cutter

Carpet Knife

Drop Seed Spreader

Flat Shovel

Loop File Cutter

Leaf Blower

Provided customer with Care & Maintenance Instructions (acquire from your SYNLawN distributor)

Provide customer with Warranty Information (customers may register their warranty by accessing our website.)

Cleaned area of all debris



Thank you for choosing SYNLawn!

Please let us know how we can be of further assistance.  
Contractor training is available upon request.

[synlawn.com](http://synlawn.com)

866.SYNLAWN